

The Box

Map £13 down

Access for everyone

We do everything we can to make The Box accessible for visitors. Head to the welcome desk or theboxplymouth.com/access for more details.

Support us

Entry to The Box is free but a £5 donation (or more) would really help. You can also support us by becoming a member. Ask at the welcome desk.

www.theboxplymouth.com



Supported using public funding by
**ARTS COUNCIL
ENGLAND**

Proudly led by Plymouth City Council in Britain's Ocean City.

Hello

Here, you'll find everything from a life sized mammoth to cutting edge contemporary art. Eight galleries. Seven exhibition spaces. Six national collections. Two million objects, archives, film, photographs, figureheads – even a ceramic crab called Colin.

Whether you've got half an hour, all day, are on your own or have the children with you: welcome. There's no 'right' way to take it all in and you certainly don't have to like everything inside.

Discover

You can't miss the flight of fourteen ship's figureheads, each with their own tale of life at sea. Discover more about Plymouth's epic relationship with the oceans in **Port of Plymouth**.

Travel the world in **100 Journeys** and film your own newsreel in **Media Lab**. Dive into our archival collections in **Active Archives**. Book a research slot in the **Cottonian Research Room** if you'd like to delve deeper.

Play

There's plenty to keep young minds and hands engaged. Pick up a family-friendly trail from the welcome desk for a fun tour of the building, or get creative at one of the **Explore More** stations next to the shop. Don't miss **Mammoth**, which is filled with thousands of specimens. Mildred can't wait to say hello.

Relax

For the best food in the city, visit **The Box Kitchen & Bar** or **The Little Box** on Tavistock Place. Children can choose from their own kid and pocket-friendly menu. Our eco-friendly **shop** is packed with products by local makers and inspired by our collections. All proceeds help support The Box.

Explore

All our exhibitions are free with no need to book in advance. We have a great variety of artists, art forms and historical insights on display for you to enjoy throughout the year. We hope you'll make the most of your visit and take the time to experience as many of them as possible. Discover more about them via the What's On section of our website or scan the QR code below.



Have you seen our event programme? Our talks, tours, live music, special events and family activities give you lots of opportunities to be creative, have fun and gain further insights into our collections and exhibitions. You can find out more from the What's On section of our website or scan the QR code above.

Visit our other venues

Uncover 400 years of history at **Elizabethan House** which has been restored and reinterpreted thanks to new research about some of the many people who have lived there over the centuries. Don't forget the iconic **Smeaton's Tower** lighthouse on the Hoe too! Both venues are open on selected dates throughout the year – please check our website for up-to-date details.

1

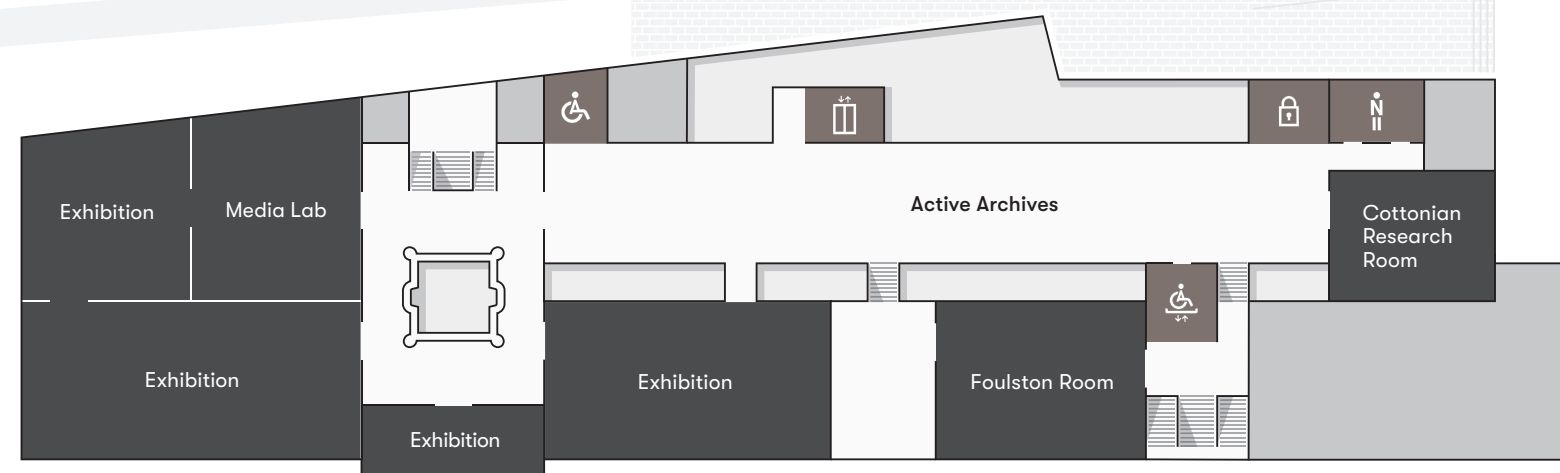

Level 1

Temporary exhibitions - please visit the What's On section of our website at theboxplymouth.com, scan the QR code below on your mobile device or speak to a member of staff or volunteer for more information

Active Archives
Media Lab
Cottonian Research Room
The University of Plymouth
Foulston Room

Toilets ♀ ♂ ♿

G

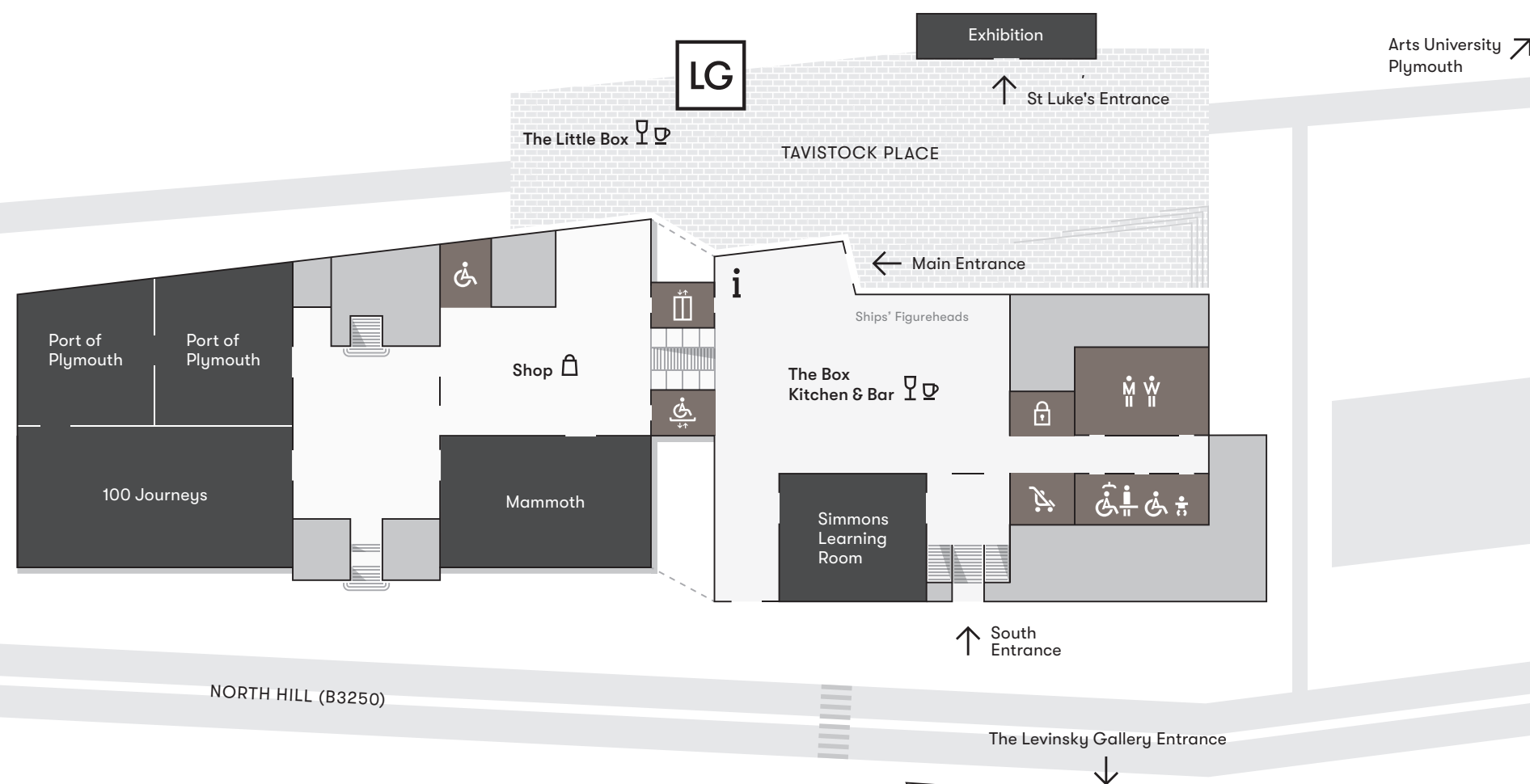

Level G

100 Journeys
Mammoth
Port of Plymouth

Shop 🏪
Toilets ♿

Level LG

Simmons Learning Room

Information i
The Box Kitchen & Bar 🍷 🍷
Buggies 🛒
Changing Places ♿
Toilets ♀ ♂ ♿

Tavistock Place

The Little Box 🍷 🍷

St Luke's

Temporary exhibitions - please visit the What's On section of our website at theboxplymouth.com, scan the QR code below on your mobile device or speak to a member of staff or volunteer for more information

